

Conversion of Loft Space

Problem - Create new separating wall in loft conversion

Solution - Slim InstaCoustic high performance wall system with timber stud - 200mm overall thickness

- A. 2 x 15mm layer of Soundbloc plasterboard
- B. New 90mm timber stud single skin separating wall with insulation quilt in void
- C. 2 x 15mm layer of Soundbloc plasterboard
- D. InstaCoustic high performance AS28 acoustic wall system incorporating a 25kg/m² sound barrier pad.

Plan Section of New Stud Separating Wall with AS28 Acoustic Wall System

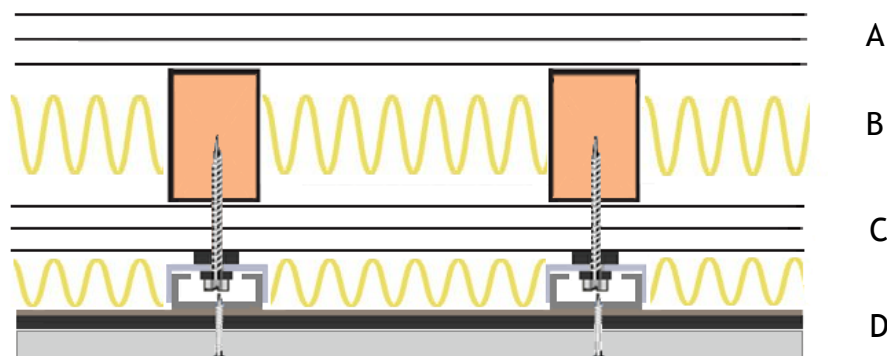

The AS28 acoustic wall should be installed within both loft roof voids

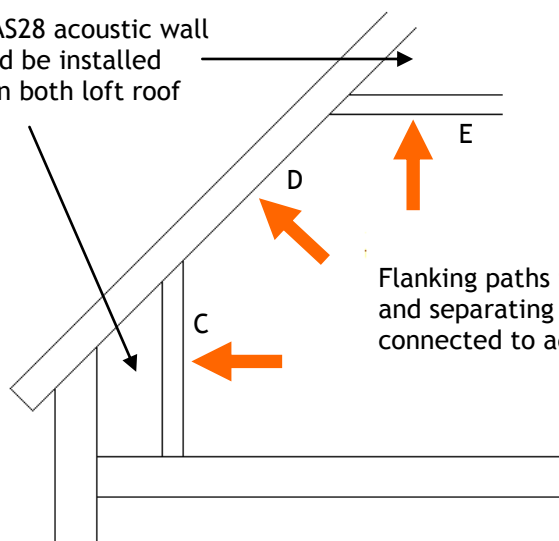

Wall marked C and ceilings marked D and E should be treated with InstaCoustic RB16 resilient bars and 2 x 15mm layers of soundbloc plasterboard to reduce flanking sound.

Flanking paths through roof line and separating walls that are connected to adjoining property

Field Sound Test Report - F26

Results	Achieved On Site	ADE Regulations
Airborne	48dB $D_nT_w + C_{tr}$	43 dB $D_nT_w + C_{tr}$

No impact tests are required for separating walls

Key Issues

- Ensure that the AS28 acoustic wall is installed on InstaCoustic isolation strips (See Registered Acoustic Solution EINS/0110/00019)
- Treat all areas of existing separating wall including roof voids (See section diagram above)
- Electrical sockets to be extended into acoustic wall with use of plasterboard boxes
- Always stagger electrical boxes in separating wall
- Ensure all acoustic hangers are fitted with isolation grommets and washers
- Ensure all acoustic hangers are fixed at the correct centres