

Material Change of Use - Separating Walls

Problem - Upgrade existing single skin masonry wall to provide separating wall between dwellings
Solution - Slim InstaCoustic high performance acoustic wall system - 165mm overall thickness

- A. Existing 9” or 4” single skin masonry wall
- B. InstaCoustic high performance AS28 acoustic wall system incorporating a 25kg/m² sound barrier pad

Plan Section of Existing Masonry Separating Wall with AS28 Acoustic Wall System

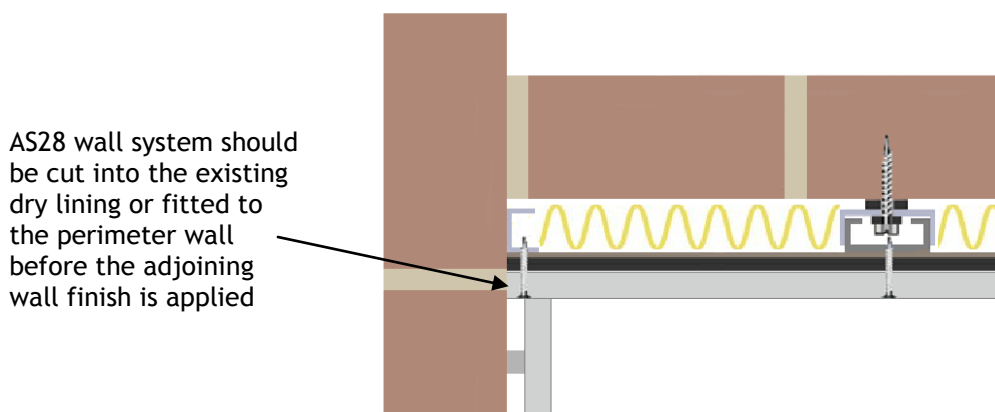
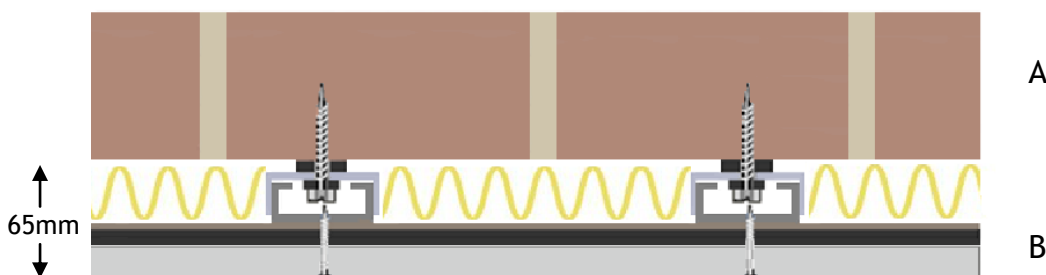

Field Sound Test Report - F57

Results	Achieved On Site	ADE Regulations
Airborne	48dB D _n T _w + C _{tr}	43 dB D _n T _w + C _{tr}

No impact tests are required for separating walls

Key Issues

- Ensure that the AS28 acoustic wall is installed on InstaCoustic isolation strips (See Registered Acoustic Solution EINS/0110/00019)
- AS28 acoustic wall should be fitted before adjoining wall finishes are applied (See diagram above)
- Electrical sockets to be extended into acoustic wall with use of plasterboard boxes
- Always stagger electrical boxes in separating wall
- Ensure all acoustic hangers are fitted with isolation grommets and washers