

ACOUSTIC CEILING SYSTEM **AC90/25FP**

The adjustable AC90/25FP provides enhanced acoustic performance and has a variable system depth ranging from 75mm to 1.5m.



SYSTEM WEIGHTS

AC90/25FP	approx 55kg/m ²
-----------	----------------------------

Weights may be subject to slight variation

THE LAYING INSTRUCTIONS MUST BE STRICTLY ADHERED TO AT ALL TIMES
THE QUALITY OF WORKMANSHIP WILL DETERMINE THE EFFECTIVENESS OF THE SYSTEM

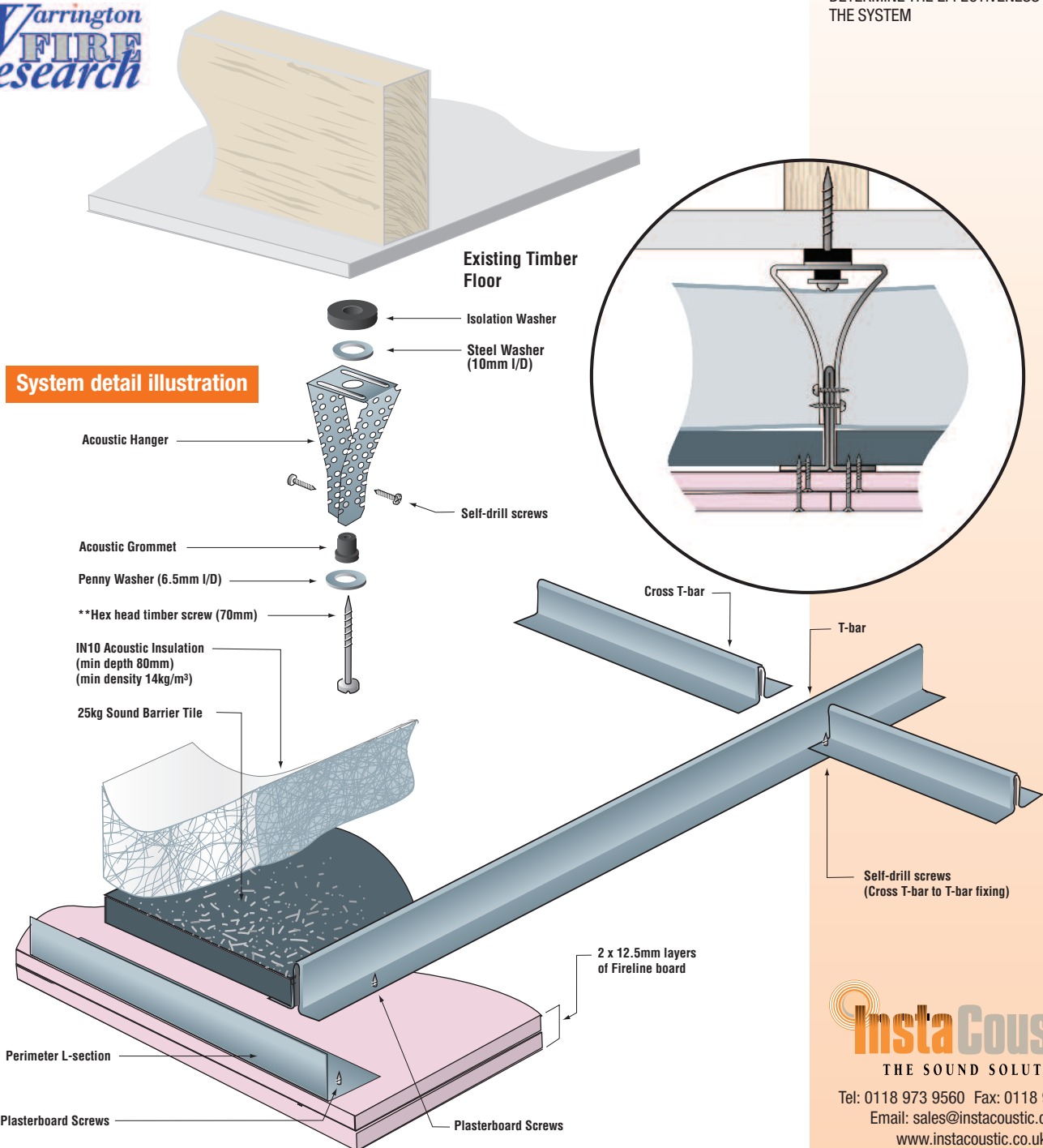

THE SOUND SOLUTION

Tel: 0118 973 9560 Fax: 0118 973 9547

Email: sales@instacoustic.co.uk

www.instacoustic.co.uk

Insta House, Ivanhoe Road

Hogwood Business Park, Finchampstead

Wokingham, Berks RG40 4PZ

ceilings

ACOUSTIC CEILING SYSTEM AC90/25FP

System view from above

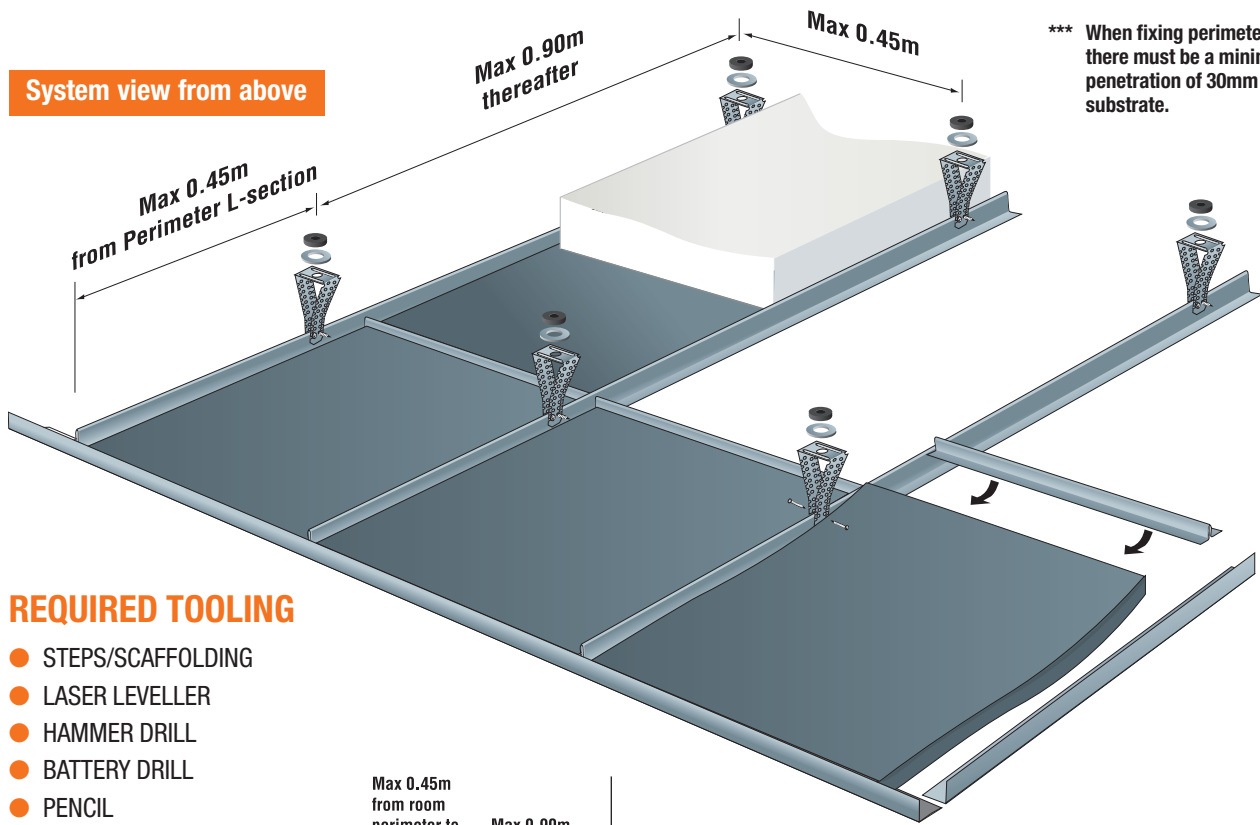

NOTES:

* System depths in excess of 150mm can be achieved with the use of 'L' section. Please refer to the InstaCoustic Technical Department for assistance.

** When fixing the acoustic hangers into timber floor joists there must be a minimum penetration of 30mm into the joist. When fixing into concrete, load tests may be required to confirm the suitability of the fixing and fixing anchor.

*** When fixing perimeter channel there must be a minimum penetration of 30mm into the substrate.

REQUIRED TOOLING

- STEPS/SCAFFOLDING
- LASER LEVELLER
- HAMMER DRILL
- BATTERY DRILL
- PENCIL
- UTILITY KNIFE
- TAPE MEASURE

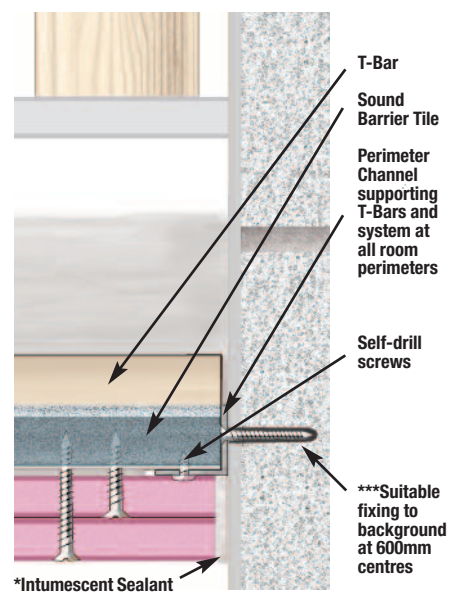
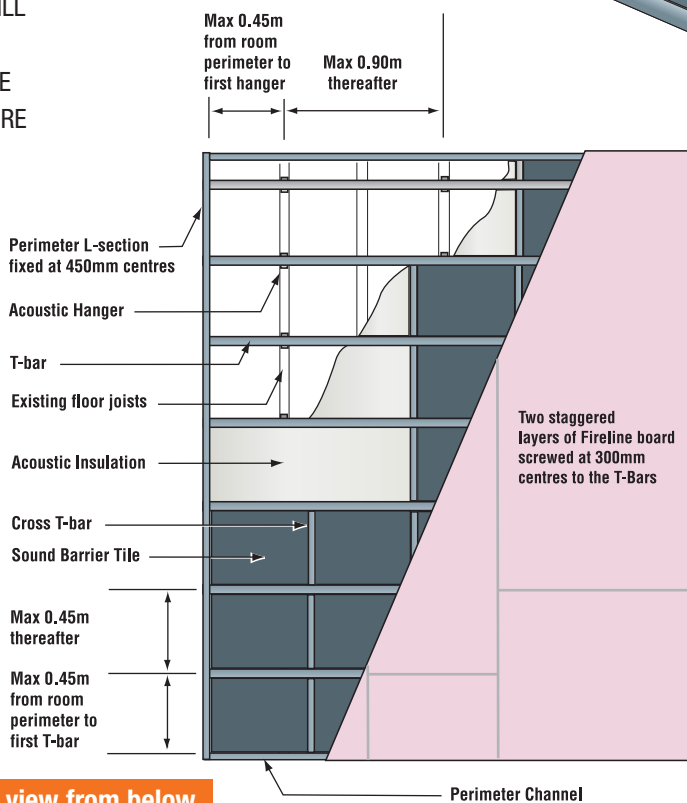

Perimeter channel detail

System plan view from below